

# ARGENTEA

## VACANT LAND - FOR SALE

Price Current as at 24<sup>th</sup> May 2010. Subject to change without notice. \* Resale

Lot	Size (m2)	Price	Street
11*	638	\$329,000	11 Lillian Road
41*	612	\$270,000	37 Muller Street
48*	600	\$279,000	20 Muller Street
70*	600	\$260,000	33 Aurelia Road
87*	778	\$275,000	55 Aurelia Road
88	681	\$300,000	55 Kurt Close
89	603	\$302,000	3 Kurt Close
90	678	\$395,000	5 Kurt Close
91	601	\$388,000	7 Kurt Close
92	613	\$399,000	9 Kurt Close
93	621	\$420,000	11 Kurt Close
94	607	\$415,000	13 Kurt Close
95	642	\$435,500	24 Kurt Close
96	798	\$447,500	22 Kurt Close
97	766	\$445,500	20 Kurt Close
98	871	\$430,500	18 Kurt Close
99	959	\$440,000	16 Kurt Close
101	867	\$410,000	12 Kurt Close
102	914	\$396,000	10 Kurt Close
103	608	\$290,000	8 Kurt Close
104	596	\$283,000	6 Kurt Close
105	601	\$275,000	4 Kurt Close
106	649	\$282,000	2 Kurt Close or 30 Aurelia Road
108	720	\$275,000	26 Aurelia Road
152*	628	\$420,000	9 Silver Close
238	675	\$288,000	28 Litara Court
239	535	\$242,000	26 Litara Court
241	630	\$297,750	22 Litara Court
242	638	\$299,000	1 Billingai Close or 20 Litara Court
243	630	\$286,000	3 Billingai Close
244	630	\$286,000	5 Billingai Close
246	705	\$299,000	10 Billingai Close U/C
247	777	\$350,000	8 Billingai Close
248	725	\$326,000	6 Billingai Close
250	605	\$290,000	2 Billingai Close or 18 Litara Court
251	600	\$263,000	16 Litara Court
255	615	\$277,000	8 Litara Court
256	694	\$296,000	6 Litara Court
257	1221	\$550,000	4 Litara Court
258	1359	\$612,000	2 Litara Court

# ARGENTEA

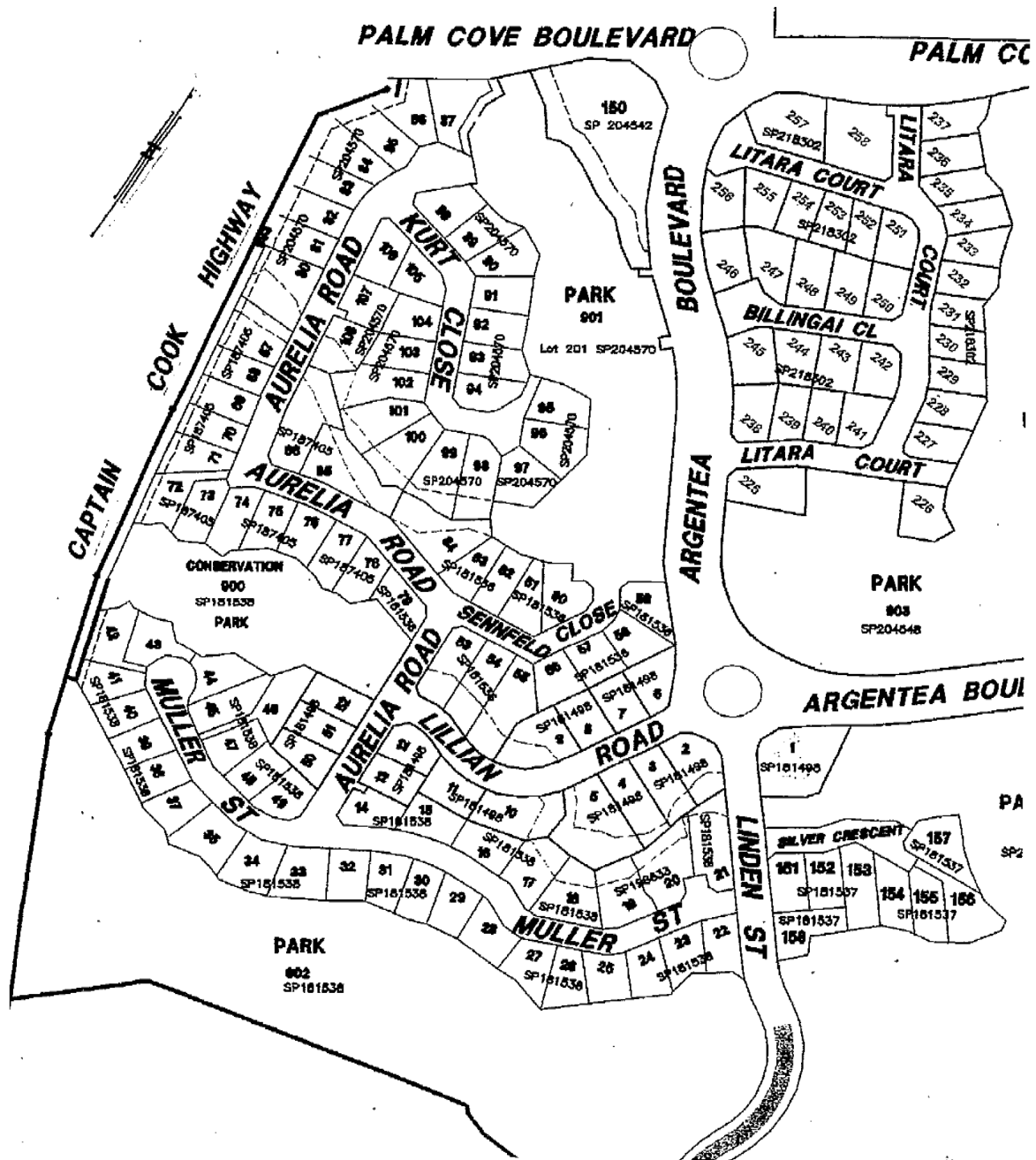

Contact Spiri: [spiri@argentea.com.au](mailto:spiri@argentea.com.au) Or Barry: [barry@argentea.com.au](mailto:barry@argentea.com.au)  
Free Call Number 1300 723 187